

# KORY RUNNING GEAR

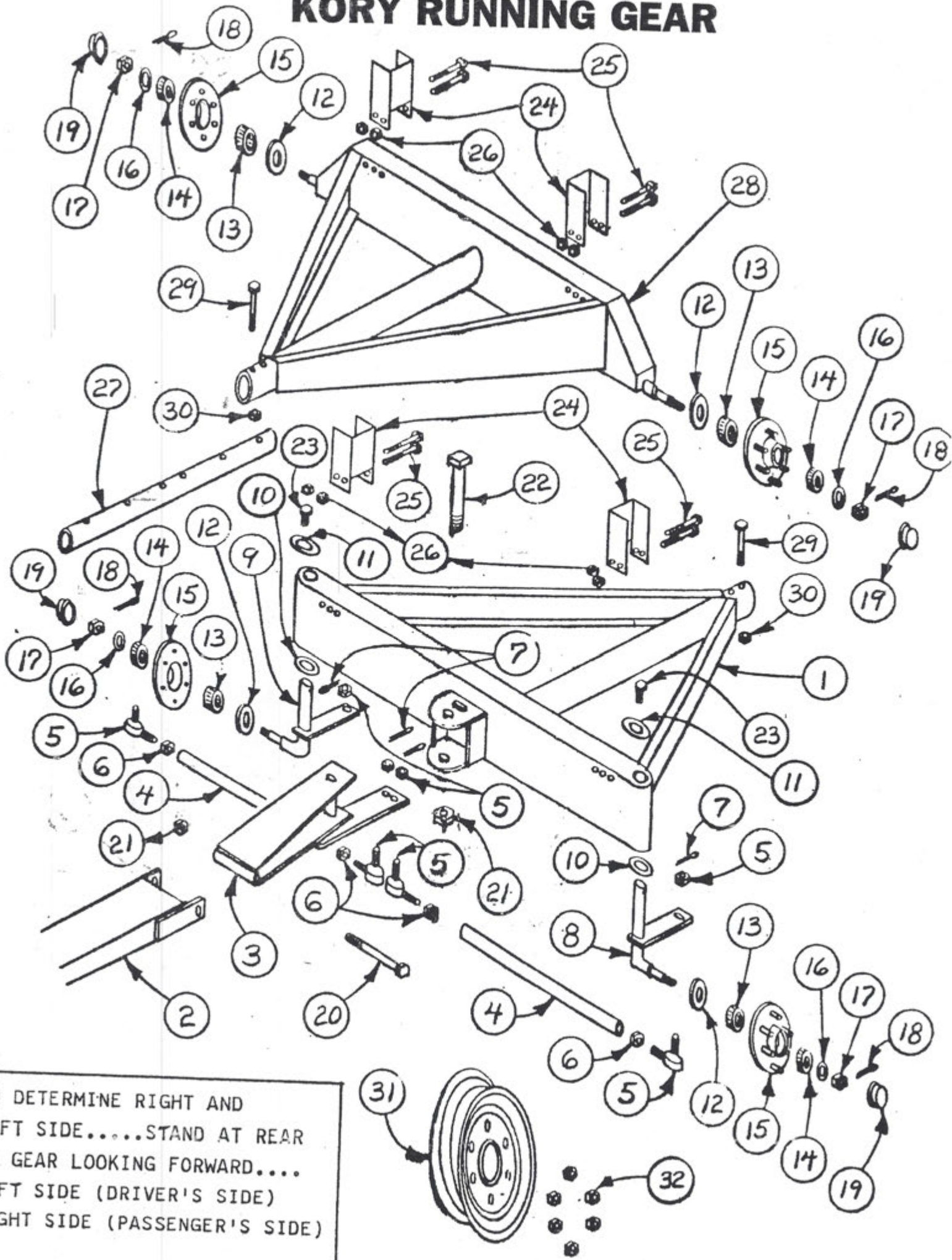

TO DETERMINE RIGHT AND  
LEFT SIDE.....STAND AT REAR  
OF GEAR LOOKING FORWARD....  
LEFT SIDE (DRIVER'S SIDE)  
RIGHT SIDE (PASSENGER'S SIDE)





# KORY FARM EQUIPMENT

P.O. Box 349, Manlius, Illinois 61338

Phone 815-445-3711

Fax 815-445-5141

## MODEL 8578 15 TON TANDEM RUNNING GEAR

ITEM	QTY.	PART NAME	PART NUMBER	
			EWC	
1	1	Front Weldment	12T1	
2	1	Quick Hitch Tongue (Heavy Duty)	A101	
3	1	Steering Piece	S117	
4	2	Tie Rod	S116	
5	2	Tie Rod End w/Slotted Nut (R.H.)	23066-K	
	2	Tie Rod End w/Slotted Nut (L.H.)	23067-K	
	4	Grease Fitting (1/8" —PT)	S127	
6	2	Jam Nut (7/8" — 18) (R.H.)	S115-R	
	2	Jam Nut (7/8" — 18) (L.H.)	S115-L	
7	4	Cotter Key (1/8" — 1/4")	S111	
8	1	Front Spindle — LH	12T3	
9	1	Front Spindle — RH	12T4	
10	2	Thrust Bearing (2-1/4)	D-29	
11	2	Cap Washer (Special)	12T6	
12	6	Seal	20148	
13	6	Inner Cone (Bearing)	25590	
14	6	Outer Cone (Bearing)	25877	
15	6	Hub Assembly — (Includes Below)	0778	
		Inner Cup	25520	
		Outer Cup	25821	
16	6	Washer (Special) Spindle	602002	
17	6	Slotted Finished Nut	7/8-14	
18	6	Cotter Key	3/16-1 1/2	
19	6	Hub Cap	615216	
20	1	Tongue Bolt (1" — 8 x 11 1/2")	S118	
21	2	Nut, Hex (1" — 8)	S120	
22	1	Steering Bolt (1" — 8 x 10 1/2")	S119	
23	2	Spindle Bolt (3/8" — 16 x 3/4")	S106	
24	4	Stake	10T7	
25	8	Stake Bolt (3/8" — 16 x 5")	10T8	
26	8	Nut, Hex (3/8" — 16)	S107	
	8	Lockwasher (3/8")	S108	
27	1	Reach (7' 0")	12TT9	
28	1	Rear Weldment	15TT2	
29	2	Reach Bolt (3/4" — 10 x 4 1/2")	S121	
30	2	Nut, Hex (3/4" — 10)	S122	
	2	Lockwasher (3/4")	S123	
31	6	Wheel (8 Bolt)	10 x 16	
	(Opt)	Wheel (8 Bolt)	10 x 15	
32	36	Lug Bolt (9/16" — 19 x 1")	105144	
33	2	Pivot Axle	12TT6	
34	2	Tandem-Axle Weldment	15TT5	
35	4	Grease Fitting (1/8" — PT 90°)	S128	
36	2	Axle Bolt (1/2" — 13 x 3 1/2")	S124	
37	2	Nut, Hex (1/2" — 13)	S125	
	2	Lockwasher (1/2")	S126	
	6	Grease Fitting (1/4" — 28) Not Shown	S114	
38	4	Machinery Bushing (2")	10T5	

4 Rear Spindle

205172



# KORY FARM EQUIPMENT

P. O. Box 349, Manlius, Illinois 61338

Phone 815-445-3711

FAX 815-445-5141

## MODEL 6278 12-TON TANDEM RUNNING GEAR

When ordering parts always **check hubs for either F&H or EWC and Number.**

ITEM	QTY.	PART NAME	PART NUMBER	
			F&H	EWC
1	1	Front Weldment	12TT1	N/A
2	1	Quick Hitch Tongue (Heavy Duty)	A101	N/A
3	1	Steering Piece	S117	N/A
4	2	Tie Rod	S116	N/A
5	2	Tie Rod End w/Slotted Nut (R.H.)	23066-K	N/A
	2	Tie Rod End w/Slotted Nut (L.H.)	23067-K	N/A
	4	Grease Fitting (1/8" — PT)	S127	N/A
6	2	Jam Nut (7/8" — 18) (R.H.)	S115-R	N/A
	2	Jam Nut (7/8" — 18) (L.H.)	S115-L	N/A
7	4	Cotter Key (1/8" — 1/4")	S111	N/A
8	1	Front Spindle — LH	12TT3	N/A
9	1	Front Spindle — RH	12TT4	N/A
10	2	Thrust Bearing (2")	T199	N/A
11	2	Cap Washer (Special)	10T6	N/A
12	6	Seal	CR-20044	N/A
13	6	Inner Cone (Bearing)	LM-501349	N/A
14	6	Outer Cone (Bearing)	LM-67048	N/A
15	6	<b>Hub Assembly — (Includes Below)</b>	<b>106164*</b>	<b>N/A</b>
		Inner Cup	LM-501310	N/A
		Outer Cup	LM-67010	N/A
16	6	Washer (Special) Spindle	104581	N/A
17	6	Slotted Finished Nut	3/4" — 16UNF	N/A
18	6	Cotter Key	3/16" x 1 1/4"	N/A
19	6	Hub Cap	103969	N/A
20	1	Tongue Bolt (1" — 8 x 11 1/2")	S118	N/A
21	2	Nut, Hex (1" — 8)	S120	N/A
22	1	Steering Bolt (1" — 8 x 10 1/2")	S119	N/A
23	2	Spindle Bolt (3/8" — 16 x 3/4")	S106	N/A
24	4	Stake	10T7	N/A
25	8	Stake Bolt (3/8" — 16 x 5")	10T8	N/A
26	8	Nut, Hex (3/8" — 16)	S107	N/A
	8	Lockwasher (3/8")	S108	N/A
27	1	Reach (7' 0")	12TT9	N/A
28	1	Rear Weldment	12TT2	N/A
29	2	Reach Bolt (3/4" — 10 x 4 1/2")	S121	N/A
30	2	Nut, Hex (3/4" — 10)	S122	N/A
	2	Lockwasher (3/4")	S123	N/A
31	6	Wheel (6-Bolt)	8 x 15	N/A
	(opt)	Wheel (6-Bolt)	10 x 15	N/A
32	36	Lug Bolt (9/16" — 18 x 1")	105144	N/A
33	2	Pivot Axle	12TT6	N/A
34	2	Tandem Axle Weldment	12TT5	N/A
35	4	Grease Fitting (1/8" — PT 90°)	S128	N/A
36	2	Axle Bolt (1/2" — 13 x 3 1/2")	S124	N/A
37	2	Nut, Hex (1/2" — 13)	S125	N/A
	2	Lockwasher (1/2")	S126	N/A
	6	Grease Fitting (1/4" — 28) Not Shown	S114	N/A
38	4	Machinery Bushing (2")	10T5	N/A

\*Hubs interchangeable with 106164: 1) 35-6 4) Q884  
 2) F 18 5) 286172  
 3) F 35 6) 6C-06

106169AS - Rear Spindle



# KORY FARM EQUIPMENT

P. O. Box 349, Manlius, Illinois 61338

Phone 815-445-3711

FAX 815-445-5141

## MODEL 8278 12-TON RUNNING GEAR

When ordering parts always **check hubs for either F&H or EWC and Number.**

ITEM	QTY.	PART NAME	PART NUMBER	
			F&H	EWC
1	1	Front Weldment	N/A	12T1
2	1	Quick Hitch Tongue (Heavy Duty)	N/A	A101
3	1	Steering Piece	N/A	S117
4	2	Tie Rod	N/A	S116
5	2	Tie Rod End w/Slotted Nut (R.H.)	N/A	23066-K
	2	Tie Rod End w/Slotted Nut (L.H.)	N/A	23067-K
	4	Grease Fitting Not Shown 1/8"-PT	N/A	S127
6	2	Jam Nut (7/8" — 18) (R.H.)	N/A	S115-R
	2	Jam Nut (7/8" — 18) (L.H.)	N/A	S115-L
7	4	Cotter Key (1/8" x 1 1/4")	N/A	S111
8	1	Front Spindle — LH	N/A	12T3
9	1	Front Spindle — RH	N/A	12T4
10	2	Thrust Bearing (2 1/4")	N/A	D-29
11	2	Cap Washer (Special)	N/A	12T6
12	4	Seal	N/A	20148
13	4	Inner Cone (Bearing)	N/A	25590
14	4	Outer Cone (Bearing)	N/A	25877
15	4	<b>Hub Assembly — (Includes Below)</b>	<b>N/A</b>	<b>Q778</b>
		Inner Cup	N/A	25520
		Outer Cup	N/A	25821
16	4	Washer (Special) Spindle	N/A	602002
17	4	Slotted Finished Nut (7/8" - 14)	N/A	32190013
18	4	Cotter Key (5/32" x 1 1/4")	N/A	32460308
19	4	Hub Cap	N/A	615216
20	1	Tongue Bolt (1" — 8 x 11 1/2")	N/A	S118
21	2	Nut (1" — 8)	N/A	S120
22	1	Steering Bolt (1" — 8 x 10 1/2")	N/A	S119
23	2	Spindle Bolt (3/8" — 16 x 3/4")	N/A	S106
24	4	Stake	N/A	10T7
25	8	Stake Bolt (3/8" — 16 x 5")	N/A	10T8
26	8	Nut, Hex (3/8" — 16)	N/A	S107
	8	Lockwasher (3/8")	N/A	S108
27	1	Reach (6' - 0")	N/A	12T9
28	1	Rear Weldment w/spindles	N/A	12T2
		Rear Spindle Only	N/A	205172
29	2	Reach Bolt (3/4" — 10 x 4 1/2")	N/A	S121
30	2	Nut, Hex (3/4" — 10)	N/A	S122
	2	Lockwasher (3/4")	N/A	S123
31	4	Wheel (8-Bolt)	N/A	10 x 16
32	32	Lug Bolt (9/16" — 18 x 1 1/8")	N/A	105144
	6	Grease Fitting <b>Not Shown</b> 1/4 — 28	N/A	S114

On old 12-tons - check frt spindle size - 2 1/8" or 2 1/4"



# KORY FARM EQUIPMENT

P.O. Box 349, Manlius, Illinois 61338 Phone 815-445-3711  
Fax 815-445-5141

## MODEL 6092 10-TON WIDE-TRACK RUNNING GEAR

When ordering parts always check hubs for either F&H or EWC and Number.

ITEM	QTY.	PART NAME	PART NUMBER
1	1	Front Weldment	10WT1
2	1	Standard Tongue	S100
	(opt)	Adjustable Tongue	A100
3	1	Steering Piece	10WT9
4	2	Tie Rod	WT116
5	2	Tie Rod End w/Slotted Nut (R.H.)	23066K
	2	Tie Rod End w/Slotted Nut (L.H.)	23067K
6	2	Jam Nut (7/8" - 18) (R.H.)	S115-R
	2	Jam Nut (7/8" - 18) (L.H.)	S115-L
7	4	Cotter Key (1/8" - 1 1/4")	S111
8	1	Front Spindle - LH	12TT3
9	1	Front Spindle - RH	12TT4
10	2	Thrust Bearing	T-199
11	2	Cap Washer (Special)	10T6
12	4	Seal	CR-20044
13	4	Inner Cone (Bearing)	LM-501349
14	4	Outer Cone (Bearing)	LM-67048
<b>15</b>	<b>4</b>	<b>Hub Assembly - (Includes Below)</b>	106164
		Inner Cup	LM-501310
		Outer Cup	LM-67010
16	4	Washer (Special) Spindle	104581
17	4	Slotted Finished Nut	3/4" - 16 UNF
18	4	Cotter Key	3/16" - 1 1/4" Lg.
19	4	Hub Cap	103969
20	1	Tongue Bolt (7/8" - 9 x 10 1/4")	S103
21	2	Nut, Hex (7/8" - 9)	S104
22	1	Steering Bolt (7/8" - 9 x 10)	10T10
23	2	Spindle Bolt (3/8" - 16 x 3/4")	S106
24	4	Stake	10T7
25	8	Stake Bolt (3/8" - 16 x 5")	10T8
26	8	Nut, Hex (3/8" - 16)	S107
	8	Lockwasher (3/8")	S108
27	1	Reach - Standard 6' long	810T9
28	1	Rear Weldment w/Spindles	10WT2
		Rear Spindle Only	106169-F
29	2	Reach Bolt (5/8" - 11 x 4 1/2")	S109
30	2	Nut, Hex (1/2" - 13)	S112
	2	Lockwasher (5/8")	S113
31	4	Wheel	8 x 15
	(opt)	Wheel	10 x 15
32	24	Lug Bolt (9/16" - 18 x 1")	105144
	8	Grease Fitting (Not Shown) 1/4" - 28	S114

\*Hubs interchangeable with 106164: 1) 286172 4) Q884  
2) 35-6 5) F18  
3) F35 6) 6C-06



# KORY FARM EQUIPMENT

P. O. Box 349, Manlius, Illinois 61338

Phone 815-445-3711

FAX 815-445-5141

## MODEL 6072 10-TON RUNNING GEAR

When ordering parts always **check hubs for either F&H or EWC and Number.**

WAGONS MANUFACTURED  
AFTER 1975

EWC HUBS USED PRIOR TO 1974

ITEM	QTY.	PART NAME	PART NUMBER		
			F&H CURRENT	EWC	EWC
1	1	Front Weldment	10T1-A	10T1-B	10T1-C
2	1	Standard Tongue	S100	*	*
	(opt)	Adjustable Tongue	A100	*	*
3	1	Steering Piece	10T9 <i>7" yoke</i>	S101 <i>4 7/8" yoke</i>	S101
4	2	Tie Rod (23 1/4" Lg.)	S102	*	*
5	2	Tie Rod End w/Slotted Nut (R.H.)	S16081	*	*
	2	Tie Rod End w/Slotted Nut (L.H.)	19273K	*	*
6	2	Jam Nut (3/4" — 16) (R.H.)	S110-R	*	*
	2	Jam Nut (3/4" — 16) (L.H.)	S110-L	*	*
7	4	Cotter Key (1/8" x 1 1/4")	S111	*	*
8	1	Front Spindle — LH	10T3-A	10T3-B	10T3-C
9	1	Front Spindle — RH	10T4-A	10T4-B	10T4-C
10	2	Machine Bushing	T-199	10T5	10T5
11	2	Cap Washer (Special)	10T6	*	*
12	4	Seal	CR-20044	CR-16289	CR-16289
13	4	Inner Cone (Bearing)	LM-501349	LM-29749	JL-69349
14	4	Outer Cone (Bearing)	LM-67048	LM-67048	LM-67048
15	4	<b>Hub Assembly — (Includes Below)</b>	<b>106164†current</b>	<b>Q777</b>	<b>Q888</b>
		Inner Cup	LM-501310	LM-29710	JL-69310
		Outer Cup	LM-67010	LM-67010	LM-67010
16	4	Washer (Special) Spindle	104581	0602002	0602002
17	4	Slotted Finished Nut	3/4" — 16 UNF	7/8" — 14 UNF	7/8" — 14 UNF
18	4	Cotter Key	3/16" x 1 1/4" Lg	5/32" x 1 1/4" Lg	5/32" x 1 1/4" Lg
19	4	Hub Cap	103969	*	*
20	1	Tongue Bolt (7/8" — 9 x 10 1/4")	S103	*	*
21	2	Nut, Hex (7/8" — 9)	S104	*	*
22	1	Steering Bolt (7/8" — 9")	10T10	S105	S105
23	2	Spindle Bolt (3/8" — 16 x 3/4")	S106	*	*
24	4	Stake	10T7	*	*
25	8	Stake Bolt (3/8" — 16 x 5")	10T8	*	*
26	8	Nut, Hex (3/8" — 16)	S107	*	*
	8	Lockwasher (3/8")	S108	*	*
27	1	Reach — Standard 6' Lg	810T9	*	*
28	1	Rear Weldment w/spindles	10T2-A	10T2-B	10T2-C
		Rear Spindle Only	106169F	0315859	03178681
29	2	Reach Bolt (5/8" — 11 x 4 1/2")	S109	*	*
30	2	Nut, Hex (5/8" — 11)	S112	*	*
	2	Lockwasher (5/8")	S113	*	*
31	4	Wheel	8 x 15	*	*
	(opt)	Wheel	10 x 15	*	*
32	24	Lug Bolt	105144	0613945	0613945
	8	Grease Fitting <b>Not Shown</b> 1/4 — 28	9/16" — 18 x 1"	1/2" — 20 x 1"	*
			S114	*	*

\* Parts are interchangeable

† Hubs interchangeable with 106164:

1) 35-6  
2) F 18  
3) F 35

4) Q884  
5) 286172  
6) 6C-06



# KORY FARM EQUIPMENT

P. O. Box 349, Manlius, Illinois 61338

Phone 815-445-3711

FAX 815-445-5141

## MODEL 6892 8-TON WIDE-TRACK RUNNING GEAR

When ordering parts always **check hubs for either F&H or EWC and Number.**

ITEM	QTY.	PART NAME	PART NUMBER
1	1	Front Weldment	8WT1
2	1	Standard Tongue	S100
	(opt)	Adjustable Tongue	A100
3	1	Steering Piece	WT101
4	2	Tie Rod	WT116
5	2	Tie Rod End w/Slotted Nut (R.H.)	23066K
	2	Tie Rod End w/Slotted Nut (L.H.)	23067K
6	2	Jam Nut (7/8" — 18) (R.H.)	S115-R
	2	Jam Nut (7/8" — 18) (L.H.)	S115-L
7	4	Cotter Key (1/8" x 1 1/4")	S111
8	1	Front Spindle — LH	8WT3
9	1	Front Spindle — RH	8WT4
10	2	Machine Bushing	8T5
11	2	Cap Washer (Special)	8T6
12	4	Seal	CR-15190
13	4	Inner Cone (Bearing)	LM-48548
14	4	Outer Cone Bearing	LM-67048
15	4	<b>Hub Assembly — (Includes Below)</b>	<b>Q709*</b>
		Inner Cup	LM-48510
		Outer Cup	LM-67010
16	4	Washer (Special) Spindle	0602002
17	4	Slotted Finished Nut	7/8" - 14 UNF
18	4	Cotter Key	5/32" x 1 1/4" Lg.
19	4	Hub Cap	103969
20	1	Tongue Bolt (7/8" — 9 x 10 1/4")	S103
21	2	Nut, Hex (7/8" — 9)	S104
22	1	Steering Bolt (7/8" — 9 x 8 1/4")	S105
23	2	Spindle Bolt (3/8" — 16 x 3/4")	S106
24	4	Stake	68T7
25	8	Stake Bolt (3/8" — 16 x 4")	68T8
26	8	Nut, Hex (3/8" — 16)	S107
	8	Lockwasher (3/8")	S108
27	1	Reach — Standard 6' Long	810T9
28	1	Rear Weldment w/Spindles	8WT2
		Rear Spindle Only	06-1472800
29	2	Reach Bolt (5/8" — 11 x 4 1/2")	S109
30	2	Nut, Hex (5/8" — 11)	S112
	2	Lockwasher (5/8")	S113
31	4	Wheel	6 x 15
	(opt)	Wheel	8 x 15
32	24	Lug Bolt (1/2" — 20 UNF 1")	0613949
	8	Grease Fitting (Not Shown) 1/4" — 28	S114

\*Hubs interchangeable with Q709: 1) 287802  
2) F-158





# KORY FARM EQUIPMENT

P. O. Box 349, Manlius, Illinois 61338

Phone 815-445-3711

FAX 815-445-5141

## MODEL 6872 8-TON RUNNING GEAR

When ordering parts always check hubs for either F&H or EWC and Number.

OLD STYLE ↓

ITEM	QTY	PART NAME	PART NUMBER	
			F&H	EWC CURRENT
1	1	Front Weldment	8T1-A	8T1-B
2	1	Standard Tongue	S100	*
	(opt)	Adjustable Tongue	A100	*
3	1	Steering Piece	S101	*
4	2	Tie Rod (23 1/4" Lg.)	S102	*
5	2	Tie Rod End w/Slotted Nut (R.H.)	S16081	*
	2	Tie Rod End w/Slotted Nut (L.H.)	19273K	*
6	2	Jam Nut (3/4" — 16) (R.H.)	S110-R	*
	2	Jam Nut (3/4" — 16) (L.H.)	S110-L	*
7	4	Cotter Key (1/8" x 1 1/4")	S111	*
8	1	Front Spindle — LH	8T3-A	8T3-B
9	1	Front Spindle — RH	8T4-A	8T4-B
10	2	Machine Bushing	8T5	*
11	2	Cap Washer (Special)	8T6	*
12	4	Seal	CR-17617	CR-15190
13	4	Inner Cone (Bearing)	LM-29749	LM-48548
14	4	Outer Cone (Bearing)	LM-67048	*LM-67048
15	4	<b>Hub Assembly — (Includes Below)</b>	<b>106749</b>	<b>Q709†</b>
		Inner Cup	LM-29710	LM-48510
		Outer Cup	LM-67010	*LM-67010
		Hub Bolt (Stud)	1/2" - 20 x 1 3/4"	N/A
16	4	Washer (Special) Spindle	104581	0602002
17	4	Slotted Finished Nut	3/4" - 16 UNF	7/8" - 14 UNF
18	4	Cotter Key	3/16" x 1 1/4" Lg	5/32" x 1 1/4" Lg
19	4	Hub Cap	103969	*
20	1	Tongue Bolt (7/8" — 9 x 10 1/4")	S103	*
21	2	Nut, Hex (7/8" — 9)	S104	*
22	1	Steering Bolt (7/8" — 9 x 8 1/4")	S105	*
23	2	Spindle Bolt (3/8" — 16 x 3/4")	S106	*
24	4	Stake	68T7	*
25	8	Stake Bolt (3/8" — 16 x 4")	68T8	*
26	8	Nut, Hex (3/8" — 16)	S107	*
	8	Lockwasher (3/8")	S108	*
27	1	Reach — Standard 6' Lg	810T9	*
28	1	Rear Weldment w/spindles	8T2-A	8T2-B
		Rear Spindle Only	106753C	06-1472800
29	2	Reach Bolt (5/8" — 11 x 4 1/2")	S109	*
30	2	Nut, Hex (5/8" — 11)	S112	*
	2	Lockwasher (5/8")	S113	*
31	4	Wheel	6 x 15	*
	(opt)	Wheel	6 x 14	*
	(opt)	Wheel	8 x 15	*
32	24	Lug Nut (1/2" — 20 UNF)	5552	N/A
	24	Lug Bolt (1/2" — 20 UNF 1")	N/A	0613945
	8	Grease Fitting <b>Not Shown</b> 1/4 — 28	S114	*

\* Parts are interchangeable

† Hubs interchangeable with Q709:

1) 287802  
2) F-158

8T-2000



# KORY FARM EQUIPMENT

P. O. Box 349, Manlius, Illinois 61338

Phone 815-445-3711

FAX 815-445-5141

## MODEL 6672 6-TON RUNNING GEAR

When ordering parts always **check hubs for either F&H or EWC and Number.**

ITEM	QTY.	PART NAME	PART NUMBER	
			F&H	EWC
1	1	Front Weldment	6T1-A	N/A
2	1	Standard Tongue	S100	N/A
	(opt)	Adjustable Tongue	A100	N/A
3	1	Steering Piece	S101	N/A
4	2	Tie Rod (25" Lg.)	S102-6	N/A
5	2	Tie Rod End w/Slotted Nut (R.H.)	S16081	N/A
	2	Tie Rod End w/Slotted Nut (L.H.)	19273K	N/A
6	2	Jam Nut (3/4" — 16) (R.H.)	S110-R	N/A
	2	Jam Nut (3/4" — 16) (L.H.)	S110-L	N/A
7	4	Cotter Key (1/8" x 1 1/4")	S111	N/A
8	1	Front Spindle — LH	6T3	N/A
9	1	Front Spindle — RH	6T4	N/A
10	2	Machine Bushing	6T5	N/A
11	2	Cap Washer (Special)	6T6	N/A
12	4	Seal	CR-16069	N/A
13	4	Inner Cone (Bearing)	LM-67048	N/A
14	4	Outer Cone (Bearing)	LM-11949	N/A
15	4	<b>Hub Assembly — (Includes Below)</b>	<b>105480</b>	<b>N/A</b>
		Inner Cup	LM-67010	N/A
		Outer Cup	LM-11910	N/A
		Hub Bolt (Stud)	1/2" - 20 x 1 1/2"	N/A
16	4	Washer (Special) Spindle	5018	N/A
17	4	Slotted Finished Nut	5/8" - 18	N/A
18	4	Cotter Key	5/32" x 1" Lg	N/A
19	4	Hub Cap	103297	N/A
20	1	Tongue Bolt (7/8" — 9 x 10 1/4")	S103	N/A
21	2	Nut, Hex (7/8" — 9)	S104	N/A
22	1	Steering Bolt (7/8" — 9 x 8 1/4")	S105	N/A
23	2	Spindle Bolt (3/8" — 16 x 3/4")	S106	N/A
24	4	Stake	68T7	N/A
25	8	Stake Bolt (3/8" — 16 x 4")	68T8	N/A
26	8	Nut, Hex (3/8" — 16)	S107	N/A
	8	Lockwasher (3/8")	S108	N/A
27	1	Reach — Standard 6' Lg	6T9	N/A
28	1	Rear Weldment w/spindles	6T2	N/A
		Rear Spindle Only	104986	N/A
29	2	Reach Bolt (5/8" — 11 x 4 1/2")	S109	N/A
30	2	Nut, Hex (5/8" — 11)	S112	N/A
	2	Lockwasher (5/8")	S113	N/A
31	4	Wheel	6 x 15	N/A
	(opt)	Wheel	6 x 14	N/A
32	24	Lug Nut (1/2" — 20)	5552	N/A
	8	Grease Fitting <b>Not Shown</b> 1/4 — 28	S114	N/A

\*Hubs interchangeable with 105480: 1) 281802-B

6T-2000



# KORY FARM EQUIPMENT

P. O. Box 349, Manlius, Illinois 61338

Phone 815-445-3711

FAX 815-445-5141

## MODEL 5566 5-TON RUNNING GEAR

When ordering parts always check hubs for F&H part number.

ITEM	QTY.	PART NAME	PART NUMBER
			F&H
1	1	Front Weldment	5T1
2	1	5-Ton Tongue	5T5
3	1	Steering Piece	5T6
4	2	Tie Rod	5T10
—	4	Tie Rod Pin	5T11
5	2	Clevis	5T12
6	2	Jam Nut (5/8" — 11)	S112
7	4	Cotter Key (1/8" x 1 1/4")	S111
8	1	Front Spindle — LH	5T3
9	1	Front Spindle — RH	5T4
10	2	Machine Bushing	6T5
11	2	Cap Washer (Special)	6T6
12	4	Seal	CR-16069
13	4	Inner Cone Bearing	LM-67048
14	4	Outer Cone Bearing	LM-11949
15	4	<b>Hub Assembly — (Includes Below)</b>	<b>104985</b>
		Inner Cup	LM-67010
		Outer Cup	LM-11910
		Hub Bolt (Stud)	(1/2" - 20 x 1 1/2")
16	4	Washer (Special) Spindle	5018
17	4	Slotted Finished Nut	5/8" - 18
18	4	Cotter Key	5/32" x 1" Lg.
19	4	Hub Cap	103297
20	1	Tongue Bolt (7/8" — 9 x 9")	5T13
21	2	Nut, Hex (7/8" — 9)	S104
22	1	Steering Bolt (7/8" — 9 x 7 3/4")	5T14
23	2	Spindle Bolt (3/8" — 16 x 3/4")	S106
24	4	Stake	5T7
25	8	Stake Bolt (3/8" — 16 x 3 1/2")	5T8
26	8	Nut, Hex (3/8" — 16)	S107
	8	Lockwasher (3/8")	S108
27	1	Reach — Standard 6'-0" Long	5T9
28	1	Rear Weldment w/spindles	5T2
		Rear Spindle Only	104986
29	2	Reach Bolt (1/2" — 13 x 13 1/2" Lg.)	S129
30	2	Nut, Hex (1/2" — 13)	S130
	2	Lockwasher (1/2")	S131
31	4	Wheel (standard)	5 x 15-5 Bolt
	4	Wheel (optional)	6 x 15-5 Bolt
32	20	Lug Nut (1/2" — 20)	5552
	4	Grease Fitting (Not Shown) 1/4" — 28	S114